

# NA - EM5

Underwater Camera Housing  
**Instruction manual**



# Foreword

Thank you for your purchase of a NAUTICAM camera housing.

At NAUTICAM, we pride ourselves on the ability to recognise the requirements of professional as well as amateur underwater photographers and fulfill them through the innovative designs of our products. We strive to achieve a high level of user-friendliness by allowing stress-free installation and easy operation of all important functions of the camera.

Each NA-EM5 housing is individually inspected and water pressure tested to ensure optimum quality.

Please read this manual carefully before using the housing, this will maximise its performance as well as its lifetime.

# Warranty

1. All NAUTICAM Products are warranted against any material and manufacturing defects for one year from the date of purchase for consumer use.
2. NAUTICAM accepts no liability for any damage to and defects in the housing caused by improper use and/or poor maintenance; it is the responsibility of the owner to carefully follow the instructions in this manual.
3. NAUTICAM does not hold responsibility for damage, of any nature, to any equipment used with and/or placed within the housing.
4. NAUTICAM accepts no liability for any loss of captured images or the inability to capture images even if it is due to the malfunctioning or leakage of the housing.
5. This warranty only applies to products purchased from authorised NAUTICAM dealers and does not extend beyond the original retail purchaser.
6. Unauthorised modifications and/or repairs of the housing will automatically invalidate this warranty.
7. To return products for service, please contact our regional distributor, normally you would need to notify them by email first and ship them the product by registered mail, along with your contact details and a brief description of the defect.

# Package Contents

1. NA-EM5 housing
2. Instruction manual
3. Spare silicone rubber housing o-ring
4. O-ring remover
5. CR2032 battery (for moisture alarm)
6. Lubricant
7. Set of Allen keys

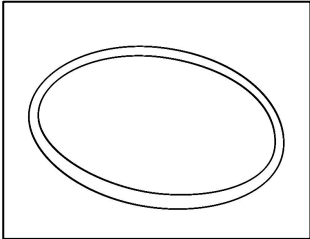

Spare silicone rubber o-ring

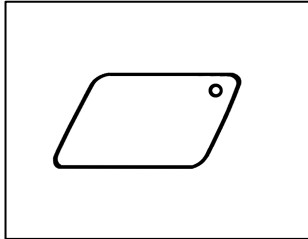

O-ring remover

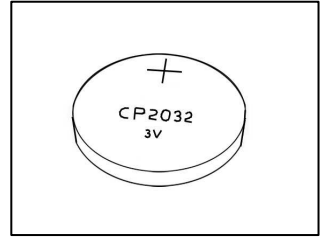

CR2032 battery

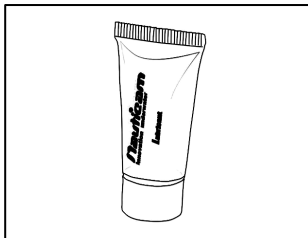

Lubricant

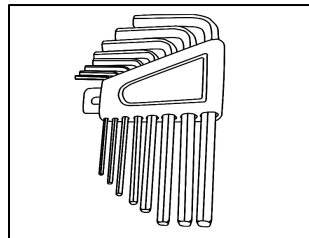

Set of Allen keys

# Precautions

1. A water-tight test without the camera inside the housing is highly recommended when using the system for the first time and after the changing of port and O-ring(s).
2. Do not use lubricants from other brands with the silicone rubber O-ring on this housing, only use the lubricant provided by NAUTICAM.
3. Discontinue use immediately should you notice any leakage.
4. Store the housing in a robust, shock-proof container during transportation; avoid transporting with any equipment, such as a camera, inside the housing.
5. When travelling by air, do not close the housing if the port is installed, as this may lead to a pressure difference between the atmosphere and inside the housing.
6. Care must be taken when opening the housing, as pressure may build up inside the housing which increases the opening force.
7. Do not open the product in a wet or sandy environment. Protect the interior from moisture and debris in order to prevent malfunction or leakage.
8. Do not store the product in an environment of high humidity.
9. Do not leave the housing and the camera in direct sunlight for prolonged periods.
10. Keep out of reach of children, failure to do so could result in injury.
11. Defective products should be shipped to our distributors for service, unauthorized disassembling and/or modifications could result in malfunction or leakage.

# Table of Contents

<i>Specifications</i>	6
<i>Identification of Parts</i>	7
<i>Preparation of the Housing</i>	12
<i>Opening and Locking the Housing</i>	14
<i>Installing the Camera</i>	15
<i>Mounting the Port</i>	16
<i>Care and Maintenance</i>	18
<i>Optional Accessories</i>	19

# Specifications

Construction	Housing body:	Aluminium alloy
	Surface treatment:	Hard anodised
	Display window:	Abrasion resistant polycarbonate
Dimensions	Width:	185mm
	Height:	152mm
	Depth:	105mm
Weight	Approx. 1.1kg (without camera)	
Buoyancy	About neutral	
Depth rating	100 metres	
Features	Moisture alarm:	Blinking LED and audible alarm
	TTL capability:	Optical fibre mount included for external strobes connection, utilising the camera's pop-up flash as trigger.
	Port mount:	Patented easy port installation system.
	Main and Sub dials:	Easily reached by thumb or forefinger.
	Fn1, Fn2 buttons:	Easily reached by thumb or forefinger.

# Identification of Parts

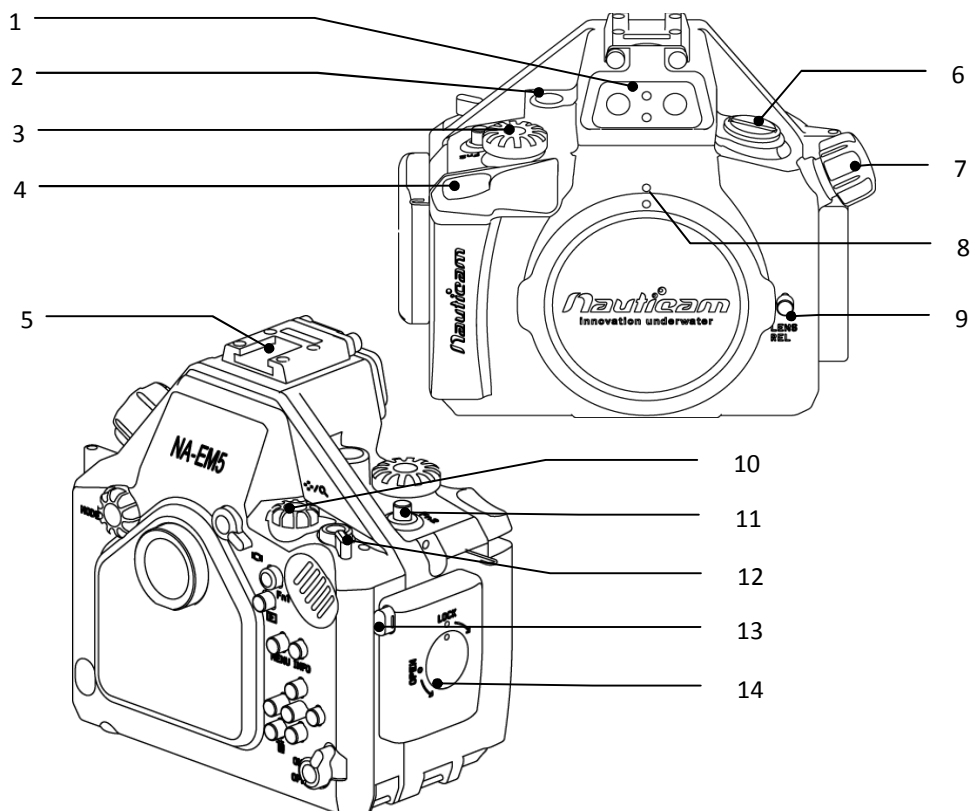

1	Optical fibre mount	8	Port alignment index
2	M10 strobe mounting base	9	Lens release button
3	Sub dial	10	Main dial
4	Shutter release lever	11	Fn2 button
5	Accessory coldshoe	12	Movie lever
6	M16 accessory socket	13	Housing lock safety button
7	Zoom/Focus knob	14	Housing lock



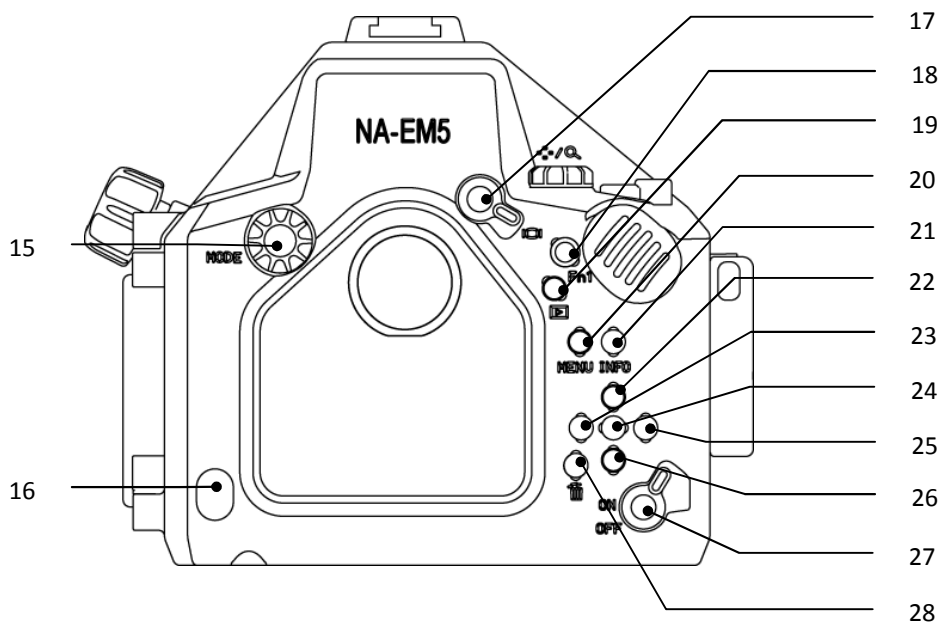

15	Mode dial	22	Up selection button
16	Moisture alarm window	23	Left selection button
17	Live view lever	24	OK button
18	Fn1 button	25	Right selection button
19	Playback button	26	Down selection button
20	Menu button	27	On/Off lever
21	Info button	28	Erase button

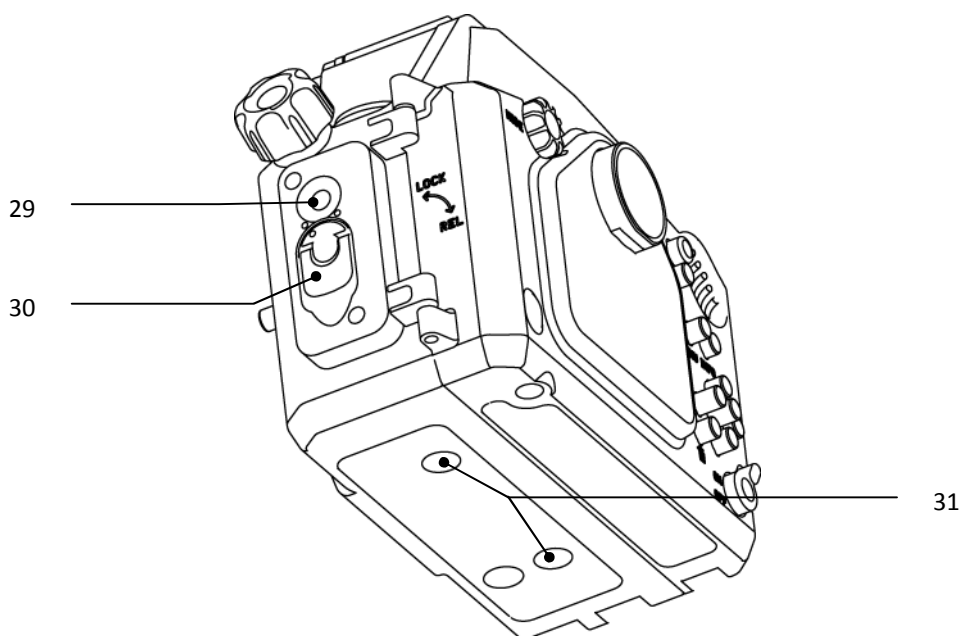

29	Port release safety button	31	1/4"-20UNC tripod socket x 2*
30	Port lock/release latch		

\* The maximum length of screws that can be used with the tripod sockets is 4mm

## Camera Settings

1. By setting the "EVF Auto Switch" function of the EM-5 camera to **Off** allows switching between monitor display and EVF display by pressing the LV button.

To disable this function, press and hold the LV button for a few seconds, the "EVF Auto Switch" menu will pop-up. Select "Off" and press OK.

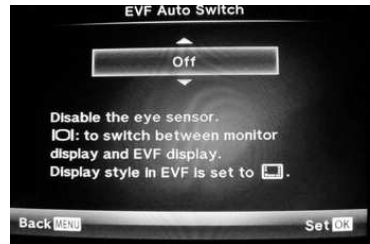

2. By setting the "Live SCP" function of the EM-5 camera to **On** allows quick access to the "Super Control Panel" under **P/A/S/M** modes by pressing the OK button.

Under Menu, scroll to Custom Menu, enter 'D' Disp/PC.



Then scroll to Control Settings and enter.

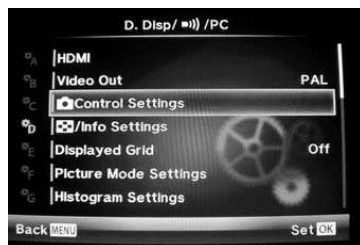

Select P/A/S/M and enter.

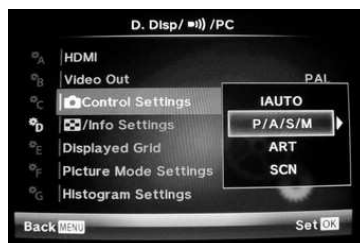

Select On and press OK.



# Preparation of the Housing

1. After verifying that the housing O-ring is in good condition, lightly coat it with the lubricant provided.
2. Make sure the O-ring groove located in the rear part of the housing is free from any foreign material; the groove can be cleaned with the aid of a microfiber cloth.
3. Place the O-ring into the groove.
4. To install the optical fibre mount for external strobe connection, fasten it with the screws provided to the threaded sockets of the accessory coldshoe as shown:

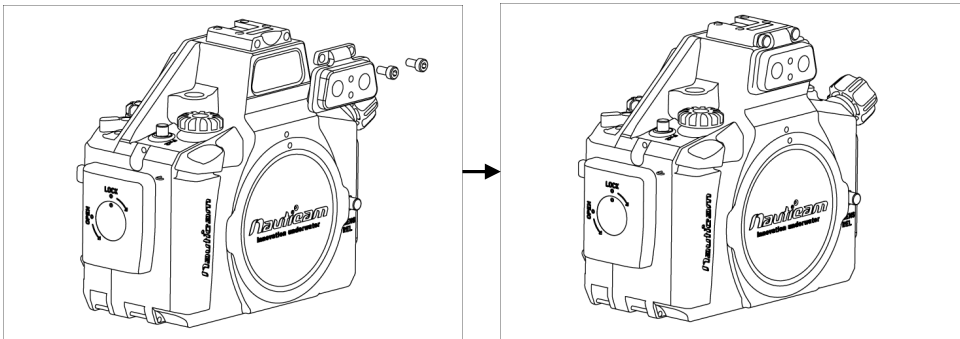

## Setting up the moisture alarm

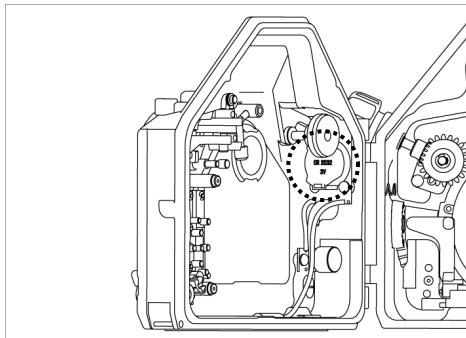

1. Install the CR2032 battery provided into the battery compartment on the circuit board inside the rear part of the housing.

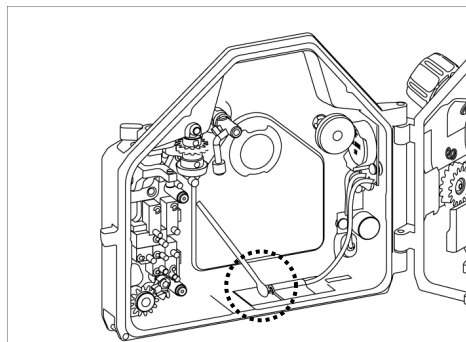

2. Test the alarm by contacting the two wires near the bottom of the housing with a damped cotton bud; the alarm should start giving out a repeating “beep” sound along with a flashing red light. The “beep” sound and the light should keep on going for 5 seconds after the removal of the damped cotton bud.

# Opening and locking the housing

To open the housing:

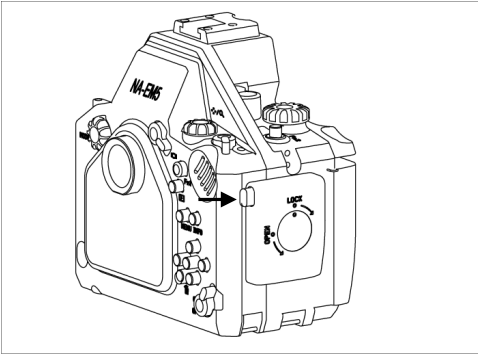

1. Press the housing lock safety button.

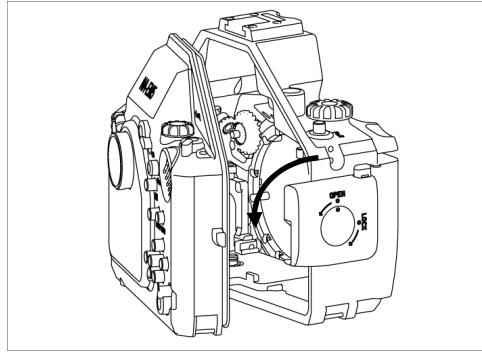

2. Turn the housing lock anti-clockwise for  $270^\circ$ , until the lock reaches the “Open” position as shown.

To lock the housing:

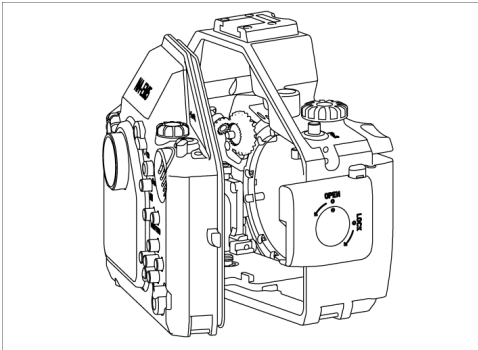

3. Close the housing while the housing lock is in the “Open” position.

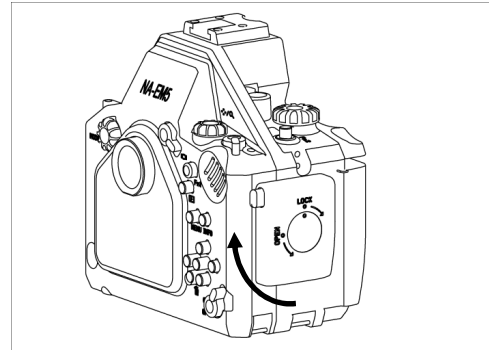

4. Turn the housing lock clockwise for  $270^\circ$ , until the lock reaches the “lock” position as shown. Confirm that the white indicator line on the safety button is visible.

# Installing the Camera

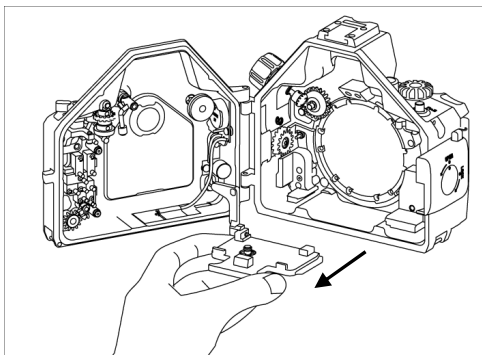

1. Remove the camera saddle from the housing by sliding it outwards.

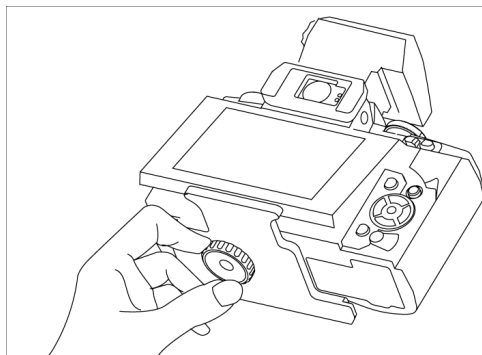

2. Attach the saddle to the camera by tightening the screw to the tripod socket of the camera.

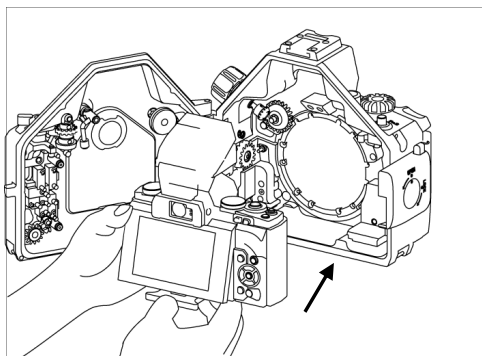

3. Install the camera by sliding the attached saddle along the rail in the housing until it cannot go in any further.



# Mounting the Port

Please refer to the NAUTICAM system port chart for a range of compatible ports.

1. Remove the O-ring from the port, inspect for any damage and lightly coat it with the provided lubricant before placing it back into its groove.
2. Verify that the port opening of the housing is clean and free from foreign material.

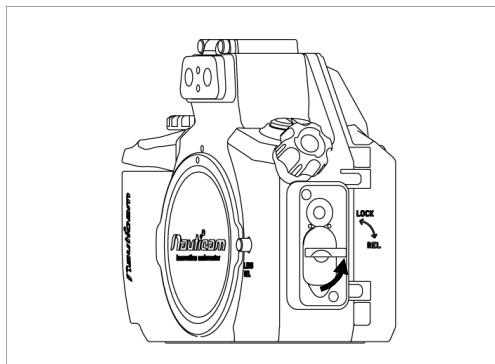

3. Lift the Port lock/release latch.

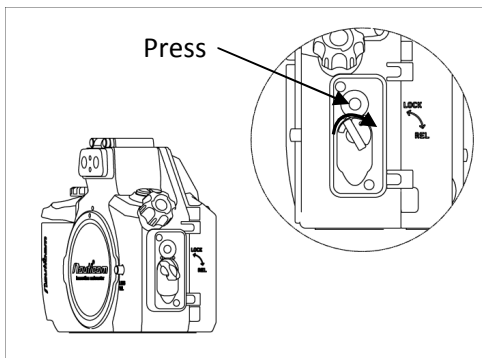

4. Press and hold the port release safety button, turn the port lock/release latch clockwise for 60° until the circle mark on the latch aligns with the “Rel” index on the rear housing.

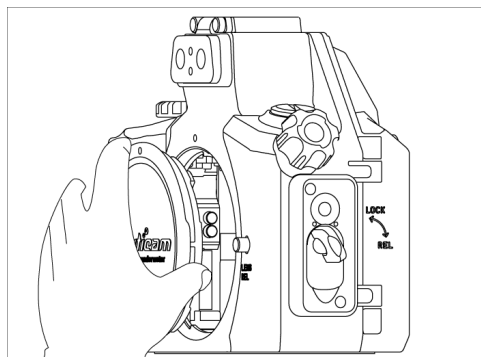

5. Lift housing cap.

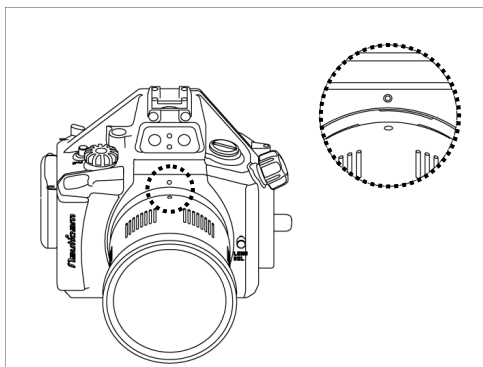

6. Align the Port mounting indices of the port and the housing.
7. Gently push the port into the port opening of the housing, until it cannot go in any further.

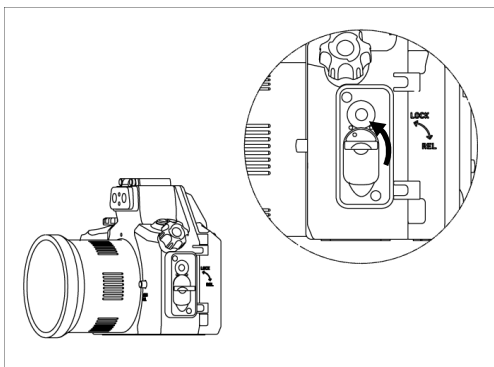

8. To lock the port in place, turn the port lock/release latch anti-clockwise for  $60^\circ$  to the "Lock" position.
9. To remove the port from the housing, repeat steps 3 and 4 then gently pull it out.

# Care and Maintenance

1. Soak the housing system in fresh water after each salt water use, during which all control buttons/knobs should be operated a few times to avoid the accumulation of salt residue; wipe the housing with a towel before opening.
2. After each day of diving, it is advisable to have the main O-ring in the rear part of the housing removed from its groove with the O-ring remover and inspected for damage. Also check that the O-ring retains its original circular shape; never stretch the O-ring excessively or remove it with a sharp object. The O-ring groove should be cleaned to ensure it is free from any salt deposit or foreign material; lightly coat the O-ring with the provided lubricant before reinstalling it in the groove. A damaged O-ring should be discarded immediately and replaced only with one that is provided by NAUTICAM.
3. Replace the main O-ring annually.
4. It is recommended that you ship the housing to our distributor for a complete overhaul every year or after every 200 dives.

# Optional Accessories

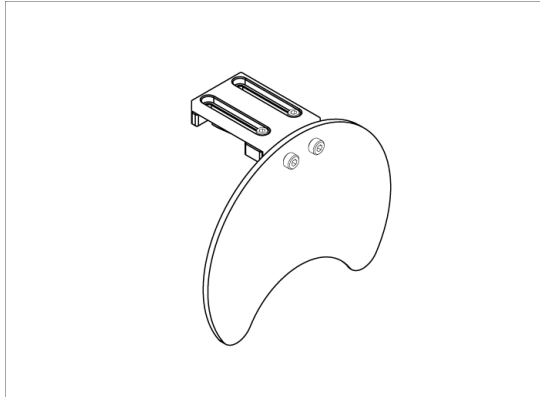

P.N. 36324

Diffuser for NA-EM5 with adjustable mount

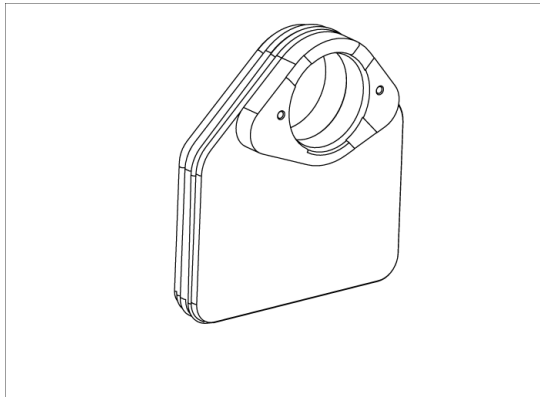

P.N. 17851

NA-EM5 LCD window for Nauticam enhanced viewfinders

**NAUTICAM International Limited**  
**Room 2203,**  
**CCT Telecom Building,**  
**11 Wo Shing Street,**  
**Fotan, HONG KONG**

**Email: [enquiry@nauticam.com](mailto:enquiry@nauticam.com)**  
**Tel: +852 2690 2711**  
**Fax: +852 2690 9778**

